



Newsletter No 77
Autumn 2022
www.osa.org.uk



OGBOURNE ST ANDREW, MAIZEY AND ROCKLEY NEWSLETTER

Welcome to the Autumn edition of the Parish Newsletter! Inside you'll find:

- ◆ **Silks update – the pub is open! See inside for opening hours and contact details**
- ◆ **Dates for your diary – Christmas Fair in Ogbourne St Andrew**
- ◆ **Village news**
- ◆ **History Group Update**
- ◆ **Church news**
- ◆ **Latest from Bay Meadows**
- ◆ **100 Club winners**



Please send contributions and ideas for articles to alexandra.hegarty@hotmail.co.uk



WE SAVED THE SILKS!

OUR VILLAGE PUB IS UP AND RUNNING ONCE MORE

After a two-year campaign, the incredible commitment of the team, and many hours of volunteer work from so many of you, it is absolutely brilliant to once again have The Silks open at the heart of our community. Cameron and his team are looking forward to meeting everyone over the coming weeks, whether for lunch, dinner or just a drink. The team are committed to ensuring The Silks is more than a pub and over the coming months the team will be delivering against their community benefit plan.

Thank you to the countless investors and amazing volunteers who have supported the campaign and refurbishment. This really was a community effort and we now have a pub we can all be proud of.





The **SILKS** *on the Downs*



OPENING TIMES

TUESDAY - SATURDAY
12pm - 3pm & 6pm - 11pm

SUNDAY
12pm - 5pm

FOOD SERVED

12pm - 2:30pm & 6pm - 9pm
Sunday 12pm - 4pm

01672 705064

hello@silksonthedowns.co.uk

Main Road, Ogbourne St Andrew, SN8 1RZ

silksonthedowns.co.uk

[@silksonthedowns](https://www.instagram.com/silksonthedowns)

Reviews: Google & Trip Advisor



COUNTRY PUB & DINING



VILLAGE NEWS

An Inconvenient Wedding

For our annual play in the garden for charity, The Walking Theatre Company performed a very interactive production of “An Inconvenient Wedding” on 15th July. The weather was perfect, and on a warm summer’s evening ice cream sales were very busy! We welcomed an audience of 250 people into the garden for this annual event at Ogbourne Maizey.

The actors weaved their way through the audience, and encouraged them to participate in this comedy of murder, mystery and intrigue. It was a light, enjoyable performance and enabled everyone to meet up with friends and picnic in the garden. We were able to give £1,725 to the Youth Adventure Trust, a local youth development charity, who support under-achieving children in local schools in the area through confidence-building programmes. These young people aged 11-16 are given the opportunity to try new things and challenge themselves to achieve their full potential.

Our grateful thanks go to all those who volunteered their help towards this fundraising event.

100 CLUB WINNERS

July 2022

1st prize Alison Williams

2nd prize Matt France

August 2022

1st prize Marian Blakeney

2nd prize Liz Wright

September 2022

1st prize John Horsey

2nd prize Richard Purchase

Why not join the 100 club?

A 100 Club is a form of lottery. Subscribers pay £2 per month and are entered into a monthly draw. All profits go to Ogbourne St Andrew Church.

First prize is 75% of the available pot, while second prize is 25%. There is no limit to the number of shares held by any one person, but no individual can win more than one prize per month. The more shares you own, the greater your chances of winning!

Apply to Ian Gordon-Finlayson, Treasurer, at iangf@f2s.com, to join the 100 Club or to increase your holding.



OGBOURNE ST ANDREW CHURCH NEWS

Ogbourne St Andrew Christmas Fair

Saturday 3rd December



**On The Green outside
Ogbourne St Andrew Church**



11.00am - 2.00pm

Stalls available for table top hire at £25.00 for anyone who would like to exhibit their own arts and crafts for sale

Church vandalism

The entrance porch to the Church in Ogbourne St Andrew has suffered recently from some minor vandalism. If you are passing through the churchyard and see any disrespectful behaviour please do contact us:

Roger Swan 01672 841322 Marion Gordon-Finlayson 01672 512125
Ogbourne St Andrew PCC

Clearing the Og

If your garden borders the River Og, please remember to do your bit to keep the watercourse running freely. Please clear any rubbish, large pieces of debris, fallen trees or branches from the river as and when you can.

It's particularly important over the winter as we prepare for the river to start flowing again. Any slowing of the flow will cause backing up and possible flooding in the villages.





HISTORY GROUP UPDATE

With the launch of the refurbished Silks in mind, time has been devoted to creating a set of historic photographs on aluminium. Together with a timeline illustrating the change of the footprint of the pub, these have been mounted in the corridor leading to the cellar. In addition, ten historical photographs of the parish have been printed and mounted in a variety of donated frames, refurbished locally. These are hung in the old 'public bar' on the exposed brick wall. Costs have been met by a grant from the History Group funds and individual donations. Our special thanks go to all the members who provided frames, mounts, printing, hard labour and expertise. The end results look excellent!

To complement the pictures and timeline, a trifold leaflet has been produced entitled 'A Short History of Pubs & Beerhouses in the parish of Ogbourne St Andrew' covering the Axe and Compass, Wheatsheaf/Silks, Old Eagle and Rockley Estate brewhouse. An initial run of 100 leaflets has been underwritten by a local donor.

Wheatsheaf to Silks 1850 - 2022

c1850	c1900	1950 - 1965	2005 - 2022
-------	-------	-------------	-------------

principal footprint changes over the years

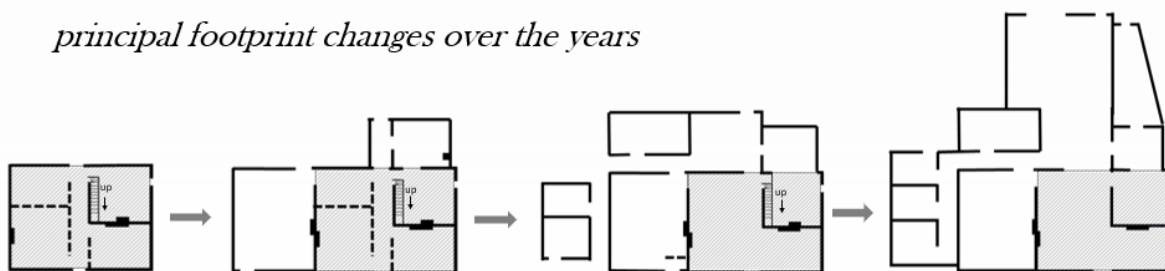

**Wheatsheaf Inn
built**
Queen Victoria
on throne
Vicarage built 1849

**Public Bar and
kitchen added**
Edward VII
crowned 1902
Railway opened 1865

**Kitchen enlarged, beer
store and external
toilets added**
Elizabeth II
crowned 1953
Axe and Compass
demolished c1951
to create car park

**Dining Room and kitchen
extended, renamed 'Silks
on the Downs'**
Elizabeth II
on throne 52 years
Acquired by Local
Community 2022



Kindly donated by members of the
Ogbourne St Andrew History Group





More research into the history not only of the pub, but the adjoining properties, has proved productive and resulted in a few more history 'rabbit holes' to delve into. As a consequence, a more detailed history of the pub will not be available until later this year or early next. In the meantime, if you have any anecdotes, memories or photographs to complement our expanding archive and to add to the interest of this project, please contact us.

Since the History Group have now become members of the Wiltshire Buildings Record, a small group of members will be attending a study day entitled '*The Romance and Mystery of Buildings*' on 1st October. This should give some impetus to the project to extend our knowledge of the buildings within the parish.

As always, do visit our website: www.osahg.org.uk

BAY MEADOWS UPDATE

Following the purchase of the Bay Meadows wildlife area by the Wiltshire Wildlife Trust last year, the Trust has made good progress on a programme of work to restore the floodplain meadow into a better habitat for species such as water vole and wild brown trout, and for pollinators.

Staff and members of the Trust, together with several groups of volunteers, have already created a wellbeing/forest school area, a den-building area and an 'enchanted tunnel'. They have also been able to identify a range of species and had sightings of water vole, brown trout and common orchid on the Og bank. Many school groups, home education, wellbeing groups, scouts, cubs, special interest groups and Youth Engagement Workers have planned to visit in the autumn and winter.

WWT hopes to provide access onto the site for members and the general public soon; in the meantime, the public are asked to bear with them while they ensure the site is safe, and fencing, paths and bridges are installed.

See the plans for the site and latest updates at:
www.wiltshirewildlife.org/bay-meadows





For your Diary

More information on planned events can be found inside this issue, or see the village website: www.osa.org.uk

Sat 3rd December, 11am-2pm: Ogbourne St Andrew Christmas Market, on The Green (outside the Church)

MULTI-MEDIA PROJECTOR FOR HIRE

The Parish and the History Group have a multi-media projector available for hire within the Parish. The modest hire charge of £5 funds the purchase of a replacement lamp.

Contact: Bruce Fox 01672 512867



Join the Facebook Community page to stay connected, offer help, ask for help or to simply chat.

Look for 'Ogbourne St Andrew, Maizey and Rockley Community'.

*This newsletter is printed by **Print Image Marlborough** with vegetable inks on EU Ecolabel paper, sourced from paper merchants certified within the FSC Group Chain of Custody Scheme.*



Please send contributions and ideas for articles to alexandra.hegarty@hotmail.co.uk